

EXISTING CONDITIONS  
SITE PLAN  
SCALE: 1" = 50' (SEE TIE LINE)  
DATUM: MEAN LOW WATER (MLW 0')  
TIDE RANGE: 1.2'

<b>BAYSHORE DESIGN, LLC</b> 9 STEAMBOAT LANDING - KINGSLEY, VA 22488 PHONE: 804/472-4433 - FAX: 804/472-2036 EMAIL: CDR@BAYSHOREDESIGN.COM	DATE: 7-22-22 DRAWN BY: PALUBINSKY	<b>PROPOSED SHORELINE STABILIZATION PROJECT</b>
© 2022 BAYSHORE DESIGN, LLC. ALL RIGHTS RESERVED. WITHOUT LIMITATION, NO REPRODUCTIONS, REVISIONS, OR MODIFICATIONS OF THESE DOCUMENTS WITHOUT THE EXPRESS WRITTEN CONSENT OF BAYSHORE DESIGN, LLC IS PROHIBITED BY LAW.	SCALE: AS NOTED SHEET: 1 OF 2	<b>WINDMILL POINT MARINA AND WESTLAND BEACH WINDMILL POINT - FLEETS ISLAND LANCASTER COUNTY, VIRGINIA</b>

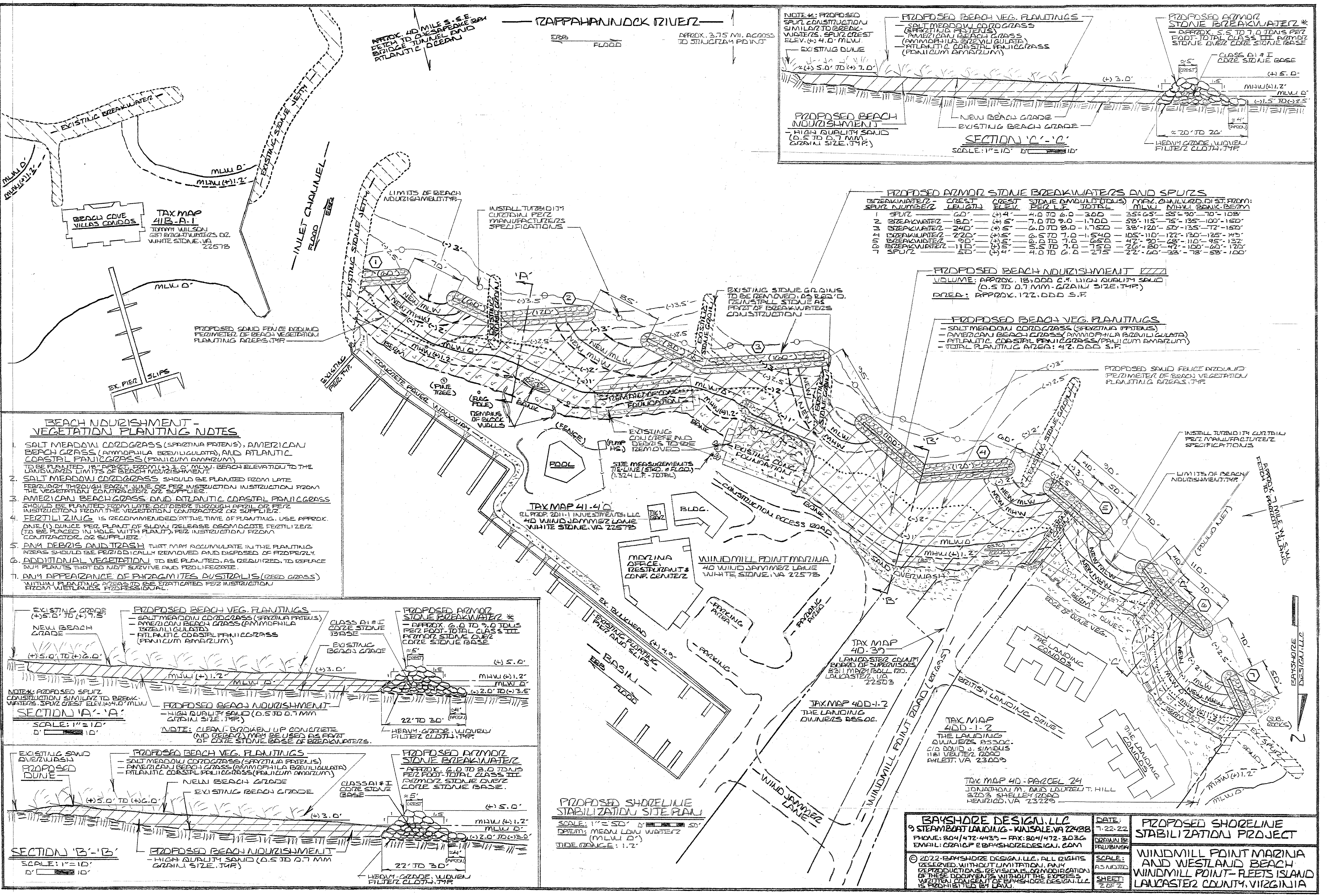



**BEACH NOURISHMENT - VEGETATION PLANTING NOTES**

1. SALT MEADOW CORDOGRASS (*SPARTINA PATENS*), AMERICAN BEACH GRASS (*AMMOPHILA BREVILIGULATA*), AND ATLANTIC COASTAL PANICGRASS (*PANICUM AMARIZUM*) TO BE PLANTED 18" APART FROM (+) 3.0' MLW BEACH ELEVATION TO THE LANDWARD LIMITS OF BEACH NOURISHMENT.
2. SALT MEADOW CORDOGRASS SHOULD BE PLANTED FROM LATE FEBRUARY THROUGH EARLY JUNE OR PER INSTRUCTION FROM THE LANDWARD LIMITS OF BEACH NOURISHMENT.
3. AMERICAN BEACH GRASS AND ATLANTIC COASTAL PANICGRASS SHOULD BE PLANTED THROUGHOUT THE BEACH NOURISHMENT AREA.
4. FERTILIZING IS RECOMMENDED AT THE TIME OF PLANTING. USE APPROX. ONE (1) POUND PER PLANT OF SLOW RELEASE OSMOCOTE FERTILIZER TO BE PLACED IN HOLE WITH PLANT. PER INSTRUCTION FROM CONTRACTOR OR SUPPLIER.
5. ANY DEBRIS AND TRASH THAT MAY ACCUMULATE IN THE PLANTING AREAS SHOULD BE PERIODICALLY REMOVED AND DISPOSED OF PROPERLY.
6. ADDITIONAL VEGETATION TO BE PLANTED, AS REQUIRED, TO REPLACE ANY PLANTS THAT DO NOT SURVIVE AND PROLIFERATE.
7. ANY APPEARANCE OF RHIZOMES AUSTRALIS (RED GRASS) WITHIN PLANTING AREAS TO BE ERADICATED PER INSTRUCTION FROM WETLANDS PROFESSIONAL.

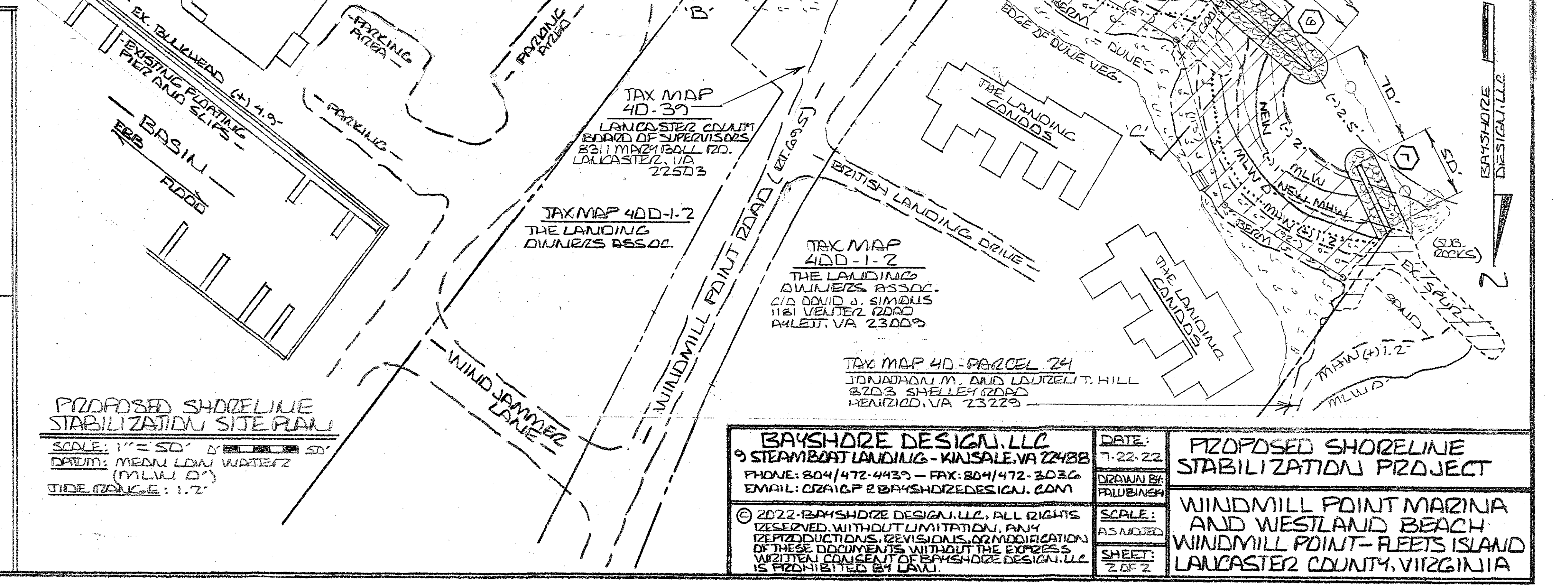
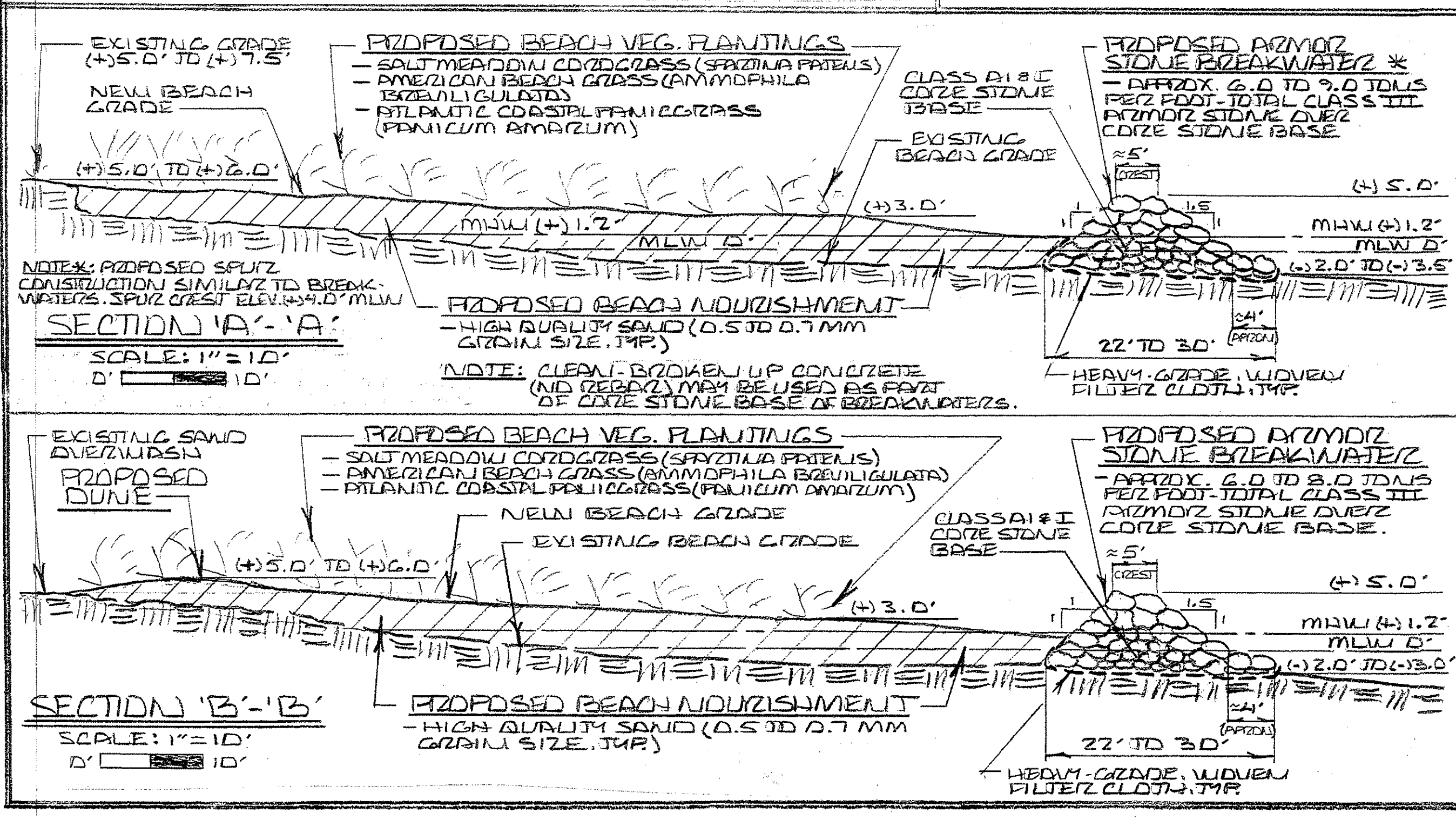

**BAYSHORE DESIGN, LLC**  
9 STEAMBOAT LANDING - KINGSLEY, VA 22488  
PHONE: 804/472-4433 - FAX: 804/472-3030  
EMAIL: INFO@BAYSHOREDESIGN.COM

DATE: 7-22-22  
DRAWN BY: JALUBINSKI  
SCALE: AS NOTED  
SHEET: 2 OF 2

**PROPOSED SHORELINE STABILIZATION PROJECT**  
WINDMILL POINT MARINA AND WESTLAND BEACH  
WINDMILL POINT - REETS ISLAND  
LANCASTER COUNTY, VIRGINIA